

December 2020

## INCOMPLETE LOCK OUT BREAKER

2. Ring left in extended position – leaving re-engagement function active (normal position during operation)

3. Lock placed through extended ring which does **NOT** lock out the re-engagement function (misleading worker to think breaker is locked out)

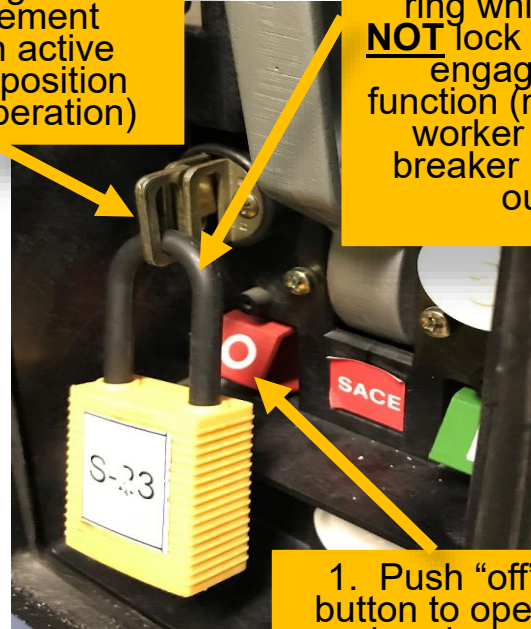

## COMPLETE LOCK OUT BREAKER

1. Push “off” button to open breaker

2. Push in middle ring to ensure lock out of re-engagement function

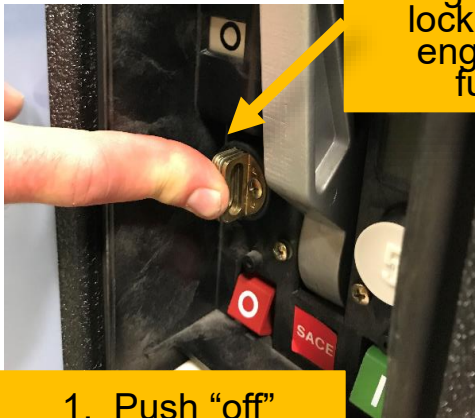

1. Push “off” button to open breaker

3. Pass lock or clip through all three rings to lock out re-engagement function

